



AMERICAN

FLOW CONTROL

THE RIGHT WAY

**5 1/4" PACER Fire Hydrant
PARTS LIST**

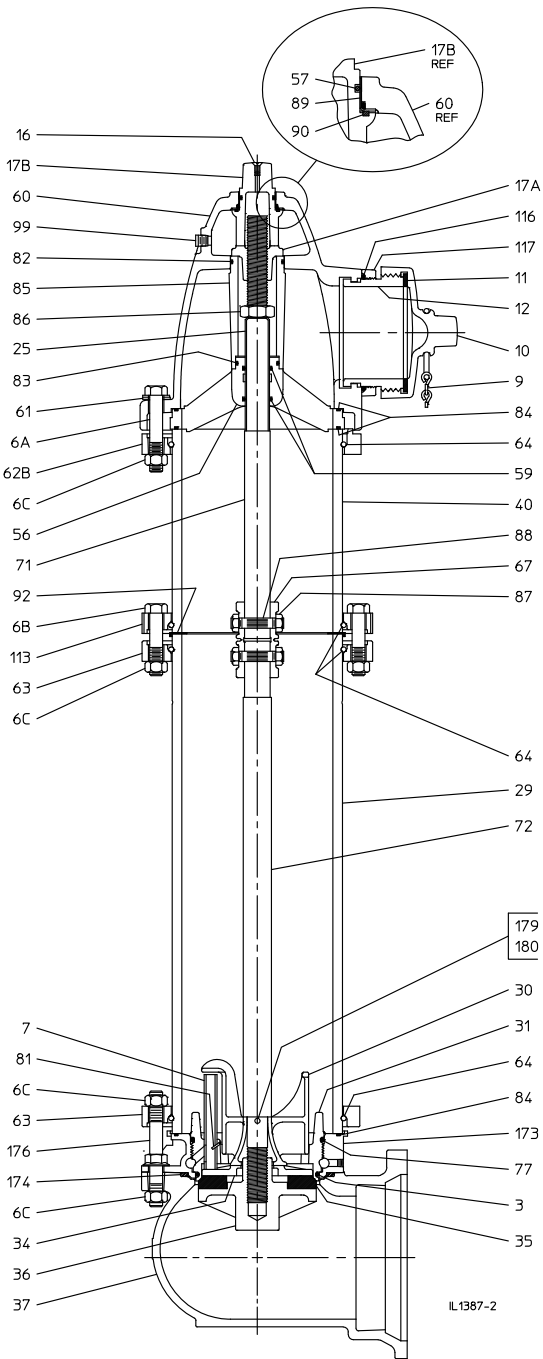

REF NO.	DESCRIPTION	MATERIAL
3	O-ring (Lower valve seat), 5-5/8 x 5-7/8	Rubber
6A	Hex hd bolt, 5/8-11 x 3-3/4 in.	Plated steel
6B	Hex hd bolt, 5/8-11 x 3 in.	Plated steel
6C	Hex nut, 5/8-11 (below grade)	Stainless steel
6C	Hex nut, 5/8-11 (above grade)	Plated steel
7	Drain plunger	Bronze
9A, 9B	Nozzle cap chain, single or double	Plated steel
10	Nozzle cap, hose or pumper	Ductile iron
11	Cap gasket, hose or pumper	Rubber
12	Nozzle, hose or pumper	Bronze
16	Flat hd screw, 1/4-20 x 1/2 in	Stainless steel
17A	Lower operating nut	Bronze
17B	Upper operating nut	Ductile iron
25	Rod bushing	Bronze
29	Lower standpipe	Centrifugally cast ductile iron pipe
30	Crossarm	Bronze
31	Valve seat	Brass
34	Upper valve washer	Ductile iron
35	Main valve rubber	Urethane
36	Lower valve washer	Ductile iron
37	Hydrant bottom	Ductile iron
40	Upper standpipe	Centrifugally cast ductile iron pipe
56	Support wheel	Ductile iron
57	O-ring (Operating nut), 1-1/2 x 1-3/4	Rubber
59	O-ring (Support wheel), 1-1/8 x 1-3/8	Rubber
60	Nozzle section	Ductile iron
61	Bury depth plate	Aluminum
61	Bury depth plate washer	Plated steel
62B	Upper standpipe flange	Ductile iron
63	Standpipe flange	Ductile iron
64	Flange lock ring	Stainless steel
67	Coupling sleeve (two halves)	Gray iron
71	Upper rod	Steel rod
72	Lower rod	Steel rod
77	O-ring (Upper valve seat), 5-7/8 x 6-1/8	Rubber
81	Groove pin, 3/32 x 7/16 in.	Copper
82	O-ring (Upper tube seal), 2-3/8 x 2-5/8	Rubber
83	O-ring (Lower tube seal), 1-7/8 x 2-1/8	Rubber
84	Support wheel/lower standpipe gasket	Rubber
85	Support tube	Ductile iron
86	Stop nut, 1"- 8	Plated steel
87	Coupling nut, 1/2-20	Brass
88	Coupling stud, 1/2-20 x 2-9/16 in.	Stainless steel
89	Nozzle section bushing	Bronze
90	Thrust ring	Polymer bearing
92	Upper standpipe gasket	Rubber
99	Pipe plug, 1/4 NPT	Brass
113	Breakable flange	Ductile iron
116	O-ring (pumper nozzle), 5-1/4 x 5-3/4	Rubber
117	Pumper nozzle retainer	Ductile iron
118	O-ring (hose nozzle), 3-1/4 x 3-5/8	Rubber
119	Hose nozzle retainer	Ductile iron
173	Valve seat insert	Brass
174	Valve seat insert gasket	Rubber
176	Stud, 5/8-11 x 5.650 in.	Stainless steel
179	Clevis pin, 1/4 x 1-11/16	Stainless steel
180	Kick-out ring	Stainless steel